

1 December 9, 1980

Introduced by: GARY GRANT
Proposed Ordinance No.:

80-1203

3 ORDINANCE NO. 5265

4 AN ORDINANCE amending Ordinance No. 4819
5 and adopting a final planned unit develop-
6 ment at the request of Raymond A Feichtmeir,
7 File No. 217-80-P

8 BE IT ORDAINED BY THE COUNCIL OF KING COUNTY:

9 SECTION 1. The King County Council on March 31, 1980,
10 adopted Ordinance No. 4819 granting preliminary approval to the
11 proposed planned unit development subject to all conditions of
12 approval being met prior to approval of final planned unit
13 development.

14 SECTION 2. The Building and Land Development Division and
15 the Zoning and Subdivision Examiner reviewed the final planned
16 unit development plan on October 10, 1980, and determined that all
17 conditions of preliminary approval have been met.

18 SECTION 3. This ordinance does hereby adopt the final
19 planned unit development for property described on Appendix A,
20 shown on Appendix B and in accordance with Appendix C, each
21 attached hereto and made a part of this ordinance and directs
22 that Area Map W 33-22-4 be modified to so designate.

23 INTRODUCED AND READ for the first time this 15th day
24 of December 1980.

25 PASSED this 22nd day of December 1980.

26 KING COUNTY COUNCIL
27 KING COUNTY, WASHINGTON

Bill Keams
28 Chairman

29 ATTEST:

30 Gwendy M. Owens DEPUTY
31 Clerk of the Council

32 APPROVED this _____ day of _____ 19 .

33 DEEMED ENACTED WITHOUT
COUNTY EXECUTIVE'S SIGNATURE.

DATED: 1/2/81
King County Executive _____

FILE NO. 217-80-P
APPENDIX A

OVERALL LEGAL DESCRIPTION:

Lot 2 of Short Plat No. 679168, Recording No. 8005120583.

Applicant: RAYMOND A. FEICHTMEIR (AKA The Tecton Company)
(AKA Ocean Ridge Apartments)

Request: A Planned Unit Development for 64 units on 5.45 acres.

STR: W 33-22-4

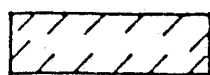

Proposed Reclassification

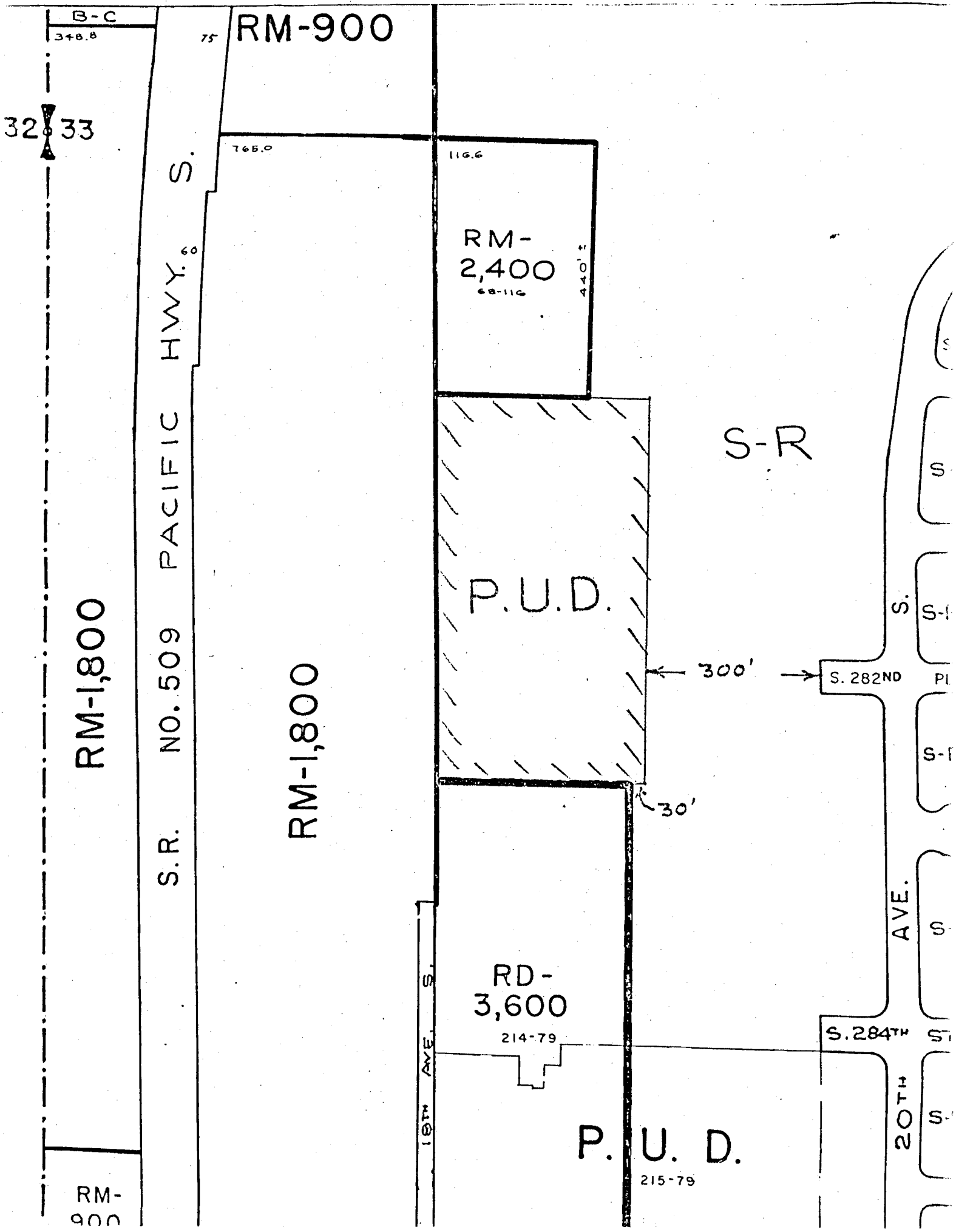

B-C

348.8

RM-900

75

32 33

765.0

116.6

RM-2,400
68-116

440.1

S-R

RM-1,800

S. NO. 509 PACIFIC HWY. 60

RM-1,800

P.U.D.

300'

S. 282ND

30'

RD-3,600
214-79

S. 18th Ave.

S. 20th Ave.

S. 284th

P. U. D.
215-79

RM-900